



# Installation Instructions

## Replacement Door Skins for 1987-2006 Jeep® Wrangler YJ/TJ Vehicles



### Parts List:

Upper Door Skin, Right - Qty 1\*

Upper Door Skin, Left - Qty 1\*

\*Where Applicable

### Required Tools:

Safety Glasses

Shoe Horn Or Large Spoon

Razor Knife

Large Beach Style Towel

### ⚠ WARNING ⚠

Loss of vehicle control involves risk of death or serious injury, particularly to parts of your body not restrained within vehicle. This product is intended for weather protection only and should not be relied upon to contain occupants in the event of an accident or to protect from either ground contact or falling objects. To reduce risk of accident or injury:

- ALWAYS WEAR SEATBELTS
- Always keep head, arms & body parts within vehicle.
- Fully secure or stow the soft top before driving according to instructions. Never try to latch or fold soft top while driving. Do not use if damaged or worn.
- Read and follow all instructions & warnings accompanying this product, in your vehicle owner's manual and Off Road Driving Supplement.

### ⚠ CAUTION ⚠

RISK OF EYE INJURY. Safety glasses should be worn at all times while installing or maintaining this product.

### ⚠ WARNING ⚠

When using a razor knife, be sure to keep hands, fingers and other body parts safely away from the knife blade. Use extreme caution as serious injury can occur.



### Important Safety information

Your MasterTop® Fabric Replacement Door Skins are intended to be used with other MasterTop Products to increase the fair weather enjoyment of your off-road capable vehicle. Before installation, please take a moment to review the following safety information and installation instructions. Important safety information is generally preceded by one of three signal words indicating the relative risk of injury. The signal words mean:

#### **⚠ WARNING ⚠**

A hazardous situation which, if not avoided, could result in death or serious injury. You CAN be KILLED or SERIOUSLY HURT if you don't follow instructions.

#### **⚠ CAUTION ⚠**

A hazardous situation which, if not avoided, could result in minor or moderate injury. You CAN be moderately HURT and also may suffer property damage if you don't follow instructions.

#### **NOTICE**

Careful attention is required to this instruction or operation but does generally not relate to personal injury. Damage to your MasterTop product or other property may result if you don't follow instructions.

### Before you begin Installation:

We are excited that you have chosen the MasterTop Fabric Replacement Door Skins. These quality products are designed to enhance your driving pleasure while providing shade shelter from rain and wind. Though we have used only the finest materials in creating this top, any product that is exposed to the elements requires some general maintenance to keep it looking like new. Please see page 5 for these important maintenance tips. Please also note that it is normal for fabric to contract and wrinkle when stored in the shipping carton. In a few days the fabric will relax and wrinkles will disappear.

#### **NOTICE**

For a smooth fit and ease of installation, this top should be installed at temperatures above 72 degrees. Below this temperature, the fabric may contract an inch or more making it difficult to install. We highly recommend taking the top out of the package and letting it sit inside a warm place or direct sunlight for 1-2 hours before you install the top. When warm, this top will install quickly.

When unpacking, check to make sure all parts are included.

If any part is missing or broken, please call MasterTop customer service at 720-575-5440.

*Color Spice  
shown for  
illustration  
on 97-06 TJ*



*Color Spice  
shown for  
illustration  
on 87-95 YJ*



## Door Skin Installation for 1997-2006 Wrangler: (for 87-95 YJ, Skip to page 4)

### **⚠ WARNING ⚠**

When using a razor knife, be sure to keep hands, fingers and other body parts safely away from the knife blade. Use extreme caution as serious injury can occur.

### **Step 1: Remove Old Upper Door Skins**

Remove the upper door fabric from the door frames. Use a razor knife to carefully cut the stitches on the upper door frame fabric and remove them from the metal door frame. See important warning at left.

FIG1

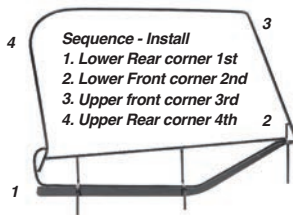

FIG2



### **Step 2: Install New Upper Door Fabric over Door Frames**

Lay a large towel on the ground and place the upper door skin on the towel to prevent scratching. Un-zip the door skin window and un-due all hook and loop fasteners on the door skin. **IMPORTANT:** See FIG 1 for the installation sequence on installing the door skin to the door frame. Place the metal frame gently into the top lower rear corner "pocket". See FIG 2.

### **NOTICE**

Door Covers are designed to fit very tight on the door frames. We highly recommend having an extra set of hands to install these door skins. In some cases a shoe horn or large spoon can be used to help work the corners of the covers over the frames without tearing the fabric. Note that we have installed a Tab on the upper rear corner of the Door Skin. Use that tab to help install the Door Skin. The Tab can be cut off when the door skin is installed. **DO NOT** pull on the weather strip when installing the door skins to the door frames.

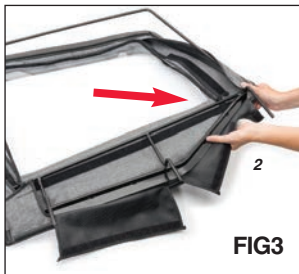

Next, work the lower front corner of the door frame into the pocket of the cover (FIG 3).

Then work the upper front corner of the frame into the cover (FIG 4). Finally, work the upper rear corner of the frame into the cover (FIG 5).

**NOTE:** the frame should fit in-between the hook and loop flaps, not between the zipper and the flaps.



With all four corners inserted into the fabric pockets, secure the final horizontal hook and loop strip above the door pins (Under the metal Horizontal Rod).

**1997-2006 Door Skin installation is now complete.**

### **⚠ WARNING ⚠**

Your MasterTop Door skins are designed to fit over your factory supplied door frames and will only provide protection from the elements. Do not rely on these soft upper doors to contain the occupants within the vehicle or to protect against injury during an accident. **WEAR SEAT BELTS AT ALL TIMES.**



**Door Skin Installation for 1987-1995 YJ Wrangler:**

**⚠ WARNING ⚠** When using a razor knife, be sure to keep hands, fingers and other body parts safely away from the knife blade. Use extreme caution as serious injury can occur.

**Step 1: Remove Old Upper Door Skins**  
Remove the upper door fabric from the door frames. Use a razor knife to carefully cut the stitches on the upper door frame fabric and remove them from the metal door frame. See important warning at left.

FIG6

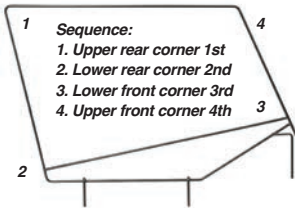

**Step 2: Install New Upper Door Fabric over Door Frames**

Lay a large towel on the ground and place the upper door skin on the towel to prevent scratching. Un-zip the door skin window and un-due all hook and loop fasteners on the door skin. **IMPORTANT:** See Fig 6 for the installation sequence on installing the door skin to the door frame. Place the metal frame gently into the top upper rear corner "pocket". See Fig 7.

**NOTICE** Door Covers are designed to fit very tight on the door frames. We highly recommend having an extra set of hands to install these door skins. In some cases a shoe horn or large spoon can be used to help work the corners of the covers over the frames without tearing the fabric. Note that we have installed a Tab on the upper rear corner of the Door Skin. Use that tab to help install the Door Skin. The Tab can be cut off when the door skin is installed. **DO NOT** pull on the weather strip when installing the door skins to the door frames.



**Step 3: Install New Upper Door Fabric over Door Frames (continued)**

Next, work the lower rear corner of the door frame into the pocket of the cover (FIG 8). Then work the lower front corner of the frame into the cover (FIG 9).

Finally, work the upper front corner of the frame into the cover (FIG 10).

**NOTE:** the frame should fit in-between the hook and loop flaps, not between the zipper and the flaps. With all four corners inserted into the fabric pockets, secure the final horizontal hook and loop strip above the door pins (Under the metal Horizontal Rod).

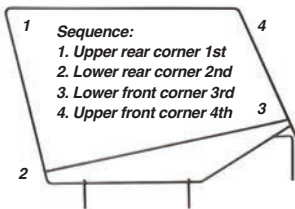

Repeat all steps for the opposite side door. Completed Upper Doors (FIG11)

**1987-1995 Door Skin installation is now complete.**



## Door Skin Installation for 1987-1995 YJ Wrangler:

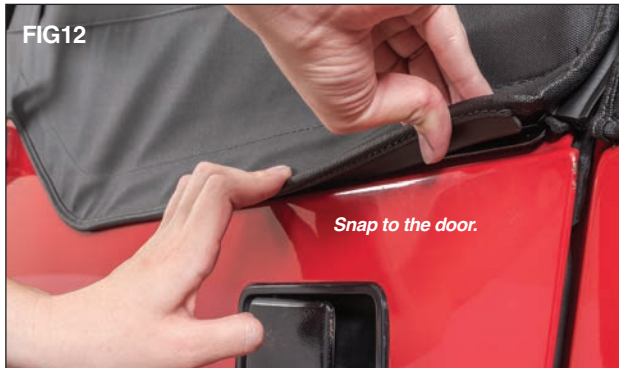

### Step 5: Install Your Upper Doors to Hard Half Doors

Install upper doors to hard half doors. Insert the pins into the door grommets in the lower hard half doors. Note that for the doors to work properly the door grommets must be un-damaged and in place. Snap the front snap on the front of the door to the snap stud on the hard half door. Work the plastic retaining strip into the door rail to secure the upper door to the hard half door. See Fig 12.

#### **⚠ WARNING ⚠**

Your MasterTop Door skins are designed to fit over your factory supplied door frames and will only provide protection from the elements. Do not rely on these soft upper doors to contain the occupants within the vehicle or to protect against injury during an accident. WEAR SEAT BELTS AT ALL TIMES.

## Care and Maintenance of your MasterTop® Product:

Your MasterTop Door Skin is made of the finest materials available but to keep it looking new and for the maximum possible wear, it will need periodic cleaning and basic maintenance. The main threat to any soft top is pollutants, dirt and grime. By keeping your product clean you will prolong the lifespan.

We recommend the following to keep your product like new:

### Washing:

The soft top fabric should be washed often using a mild soap, warm water and a soft bristle brush. You can also use special soft top cleaners available on our Distributors websites. Make sure that after cleaning you rinse with clear water to remove all traces of soap to avoid residue.

### Water/Fabric:

In the event of seeping through the seams, 3M Scotchgard® may be applied on the inside of the seams to stop the seeping. Rips in the fabric may be repaired with Bondex® iron on patches. Iron the patches to the Inside of the top, carefully following the Bondex® instructions.

### Windows:

It is very important that you keep your Soft Top windows clean! Use a mild soap and water solution to gently clean your windows. NEVER wipe your windows clean with a dry cloth! Dust and dirt on a dry cloth can scratch your windows causing "fogging" and permanent damage. When removing your windows, store them with a towel. If frost or ice forms on the outside of your windows during the winter, DO NOT use an ice scraper to remove this frost. Over time you will see small micro scratches in your windows which are natural wear and tear. These Micro scratches can be "polished" out using the window polish available at your MasterTop Distributor.

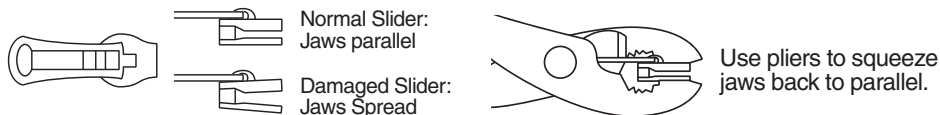

### Zippers:

Keeping the zipper cleaned and lubricated with a silicone lubricant (available online) will help prevent damage and keep the zippers in a smooth working condition. If zipper opens behind the slider, the slider may have been spread apart. This problem can usually be fixed by using an ordinary pair of pliers to bring the sides back into parallel. Return slider to the end of the zipper in the normal Open position. Squeeze lightly at first and test zipper. If the zipper continues to remain open squeeze more firmly with pliers and try the zipper again. Repeat procedure until your zipper operates correctly.





## Limited 3 Year Warranty

Your MasterTop® accessory is covered by the following Limited Warranty provided exclusively by MasterTop, Inc., 420 J Corporate Circle, Golden, CO 80401.

This Limited Warranty is the only warranty made in connection with your purchase. MasterTop neither assumes nor authorizes any vendor, retailer or other person or entity to assume for it any other obligation or liability in connection with this product or Limited Warranty. This Limited Warranty does not apply and is not cumulative to any accessory or part distributed by any MasterTop distributor for which the Manufacturer provides a separate written warranty.

**What is Covered:** Subject to the terms, exclusions and limitations herein and with respect only to MasterTop branded accessories first sold in the United States, MasterTop warrants to the initial retail purchaser only that your MasterTop accessory shall be free of defects in material and workmanship; **for a period of 3 years from date of initial retail sale.**

All other warranties are hereby disclaimed, except to the extent prohibited by applicable law in which case any implied warranty of merchantability or fitness for a particular purpose on this product is **limited to 3 years from date of initial retail sale.** MasterTop reserves the rights to: (a.) require invoice or other proof your product is within the terms of this Limited Warranty as a condition of warranty service and, (b.) make future revisions to this product and Limited Warranty without prior notice or obligation to upgrade your product.

**What is Not Covered:** Your MasterTop Limited Warranty does not cover products or parts MasterTop determines to have been damaged by or subjected to: (a.) installation damage, alteration, modification, failure to maintain or attempted repair or service by anyone not authorized by MasterTop, (b.) normal wear and tear, cosmetic damage or damage from water immersion, (c.) Acts of God, accidents, misuse, negligence, inadequate mounting or impact with vehicle(s), obstacles or other aspects of the environment, (d.) theft, vandalism or other intentional damage, (e.) fleet, rental or commercial use, (f.) use in competition or racing.

**Remedy Limited to Repair/Replacement:** The exclusive remedy provided hereunder shall, upon MasterTop inspection and at MasterTop's option, be either repair or replacement of product or parts (new or refurbished) covered under this Limited Warranty. Customers requesting warranty consideration on MasterTop Products should first contact MasterTop to obtain a RGA number (720-575-5440). All labor, removal, shipping and installation costs are customer's responsibility.

### **Other Limitations - Exclusion of Damages - Your Rights Under State Law:**

In consideration of the purchase price paid, neither MasterTop nor any independent MasterTop distributor /licensee are responsible for any time loss, rental costs, or for any incidental, consequential, punitive or other damages you may have or incur in connection with any part or product purchased. Your exclusive remedy hereunder for covered parts is repair/replacement as described above.

This Limited Warranty gives you specific rights. You may also have other rights that vary from state to state. For example, some states do not allow limitations of how long an implied warranty lasts and/or do not allow the exclusion or limitation of incidental or consequential damages, so the limitations and exclusions herein may not apply to you.

©MasterTop, Inc. 2018. All Rights Reserved. The term MasterTop® is a Registered Trademark of MasterTop Incorporated, Registered in U.S. Patent and Trademark Office.

[www.MasterTop.com](http://www.MasterTop.com)

Part #941031.01 Version 12.19.18 LTR

